

FH127-XXX-XXX  
 Female Header  
 Pitch 1.27mm  
 2: Dual Row  
 1: Single Row  
 Type1/Type2  
 .....  
 No. of Pins  
 Dual Row: 2~50  
 Single Row: 2~50

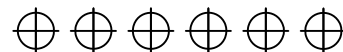
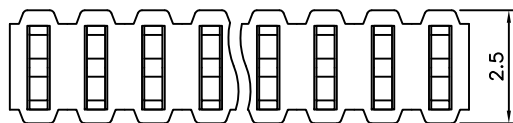
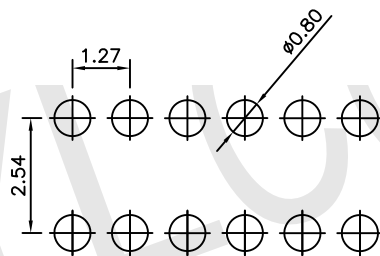
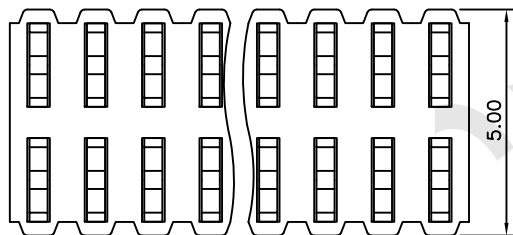

PRODUCT SPECIFICATION

1. INSULATOR MATERIAL : POLYESTER, UL94V-0 .
2. TERMINAL MATERIAL : COPPER ALLOY .
3. FINISH : GOLD OR TIN PLATED.
4. CURRENT RATING : 1 AMPERE.
5. INSULATION RESISTANCE : 1000M OHMS MIN.
6. DIELECTRIC WITHSTANDING VOLTAGE : 1000 V /1 MINUTE.
7. CONTACT RESISTANCE : 初期 Initial : 20 m Ohm Max. ;  
测试后 Final : 40 m Ohm Max. .
8. OPERATING TEMPERATURE : - 40°C to +105°C.

THIS DRAWING IS A CONTROLLED DOCUMENT.		DWN 08012016	东莞市宇亮电子有限公司 DONG GUAN YU LIANG ELECTRONICS CO.,LTD	
		CHEK 08Jan2016		
 THIRD ANGLE PROJECTION		TOLERANCES UNLESS OTHERWISE SPECIFIED:		NAME Female Header 1.27mm*4.6mm Type
		0 PLC ± 0.50 1 PLC ± 0.30 2 PLC ± 0.20 3 PLC ± 0.15 4 PLC ± - ANGLES ± 3°		APVD Abel 08Jan2016
		PRODUCT SPEC -	SIZE A4	SCALE 1 : 1
		WEIGHT -	SHEET 1 of 1	
		CUSTOMER DRAWING		

RoHS  
compliant

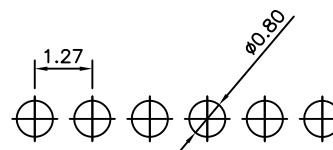
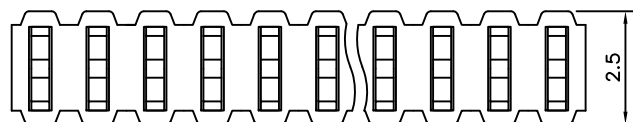
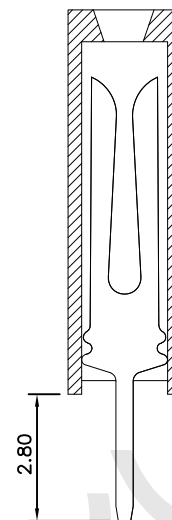
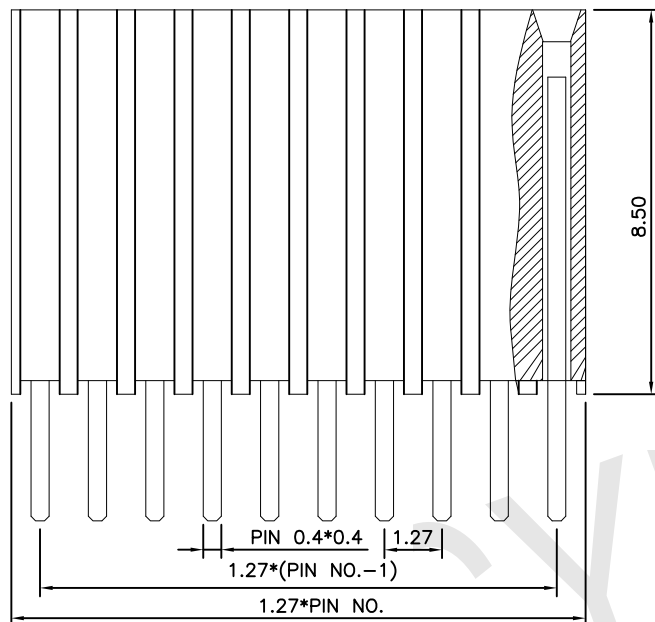

FH127-XXX-XXX  
 Female Header  
 Pitch 1.27mm  
 Single Row  
 Type1/Type2  
 .....  
 No.of Pins  
 Single Row:2~50

PRODUCT SPECIFICATION

- 1.INSULATOR MATERIAL : POLYESTER, UL94V-0 .
- 2.TERMINAL MATERIAL : COPPER ALLOY .
- 3.FINISH : GOLD OR TIN PLATED.
- 4.CURRENT RATING : 1 AMPERE.
5. NSULATION RESISTANCE : 1000M OHMS MIN.
6. DIELECTRIC WITHSTANDING VOLTAGE : 1000 V /1 MINUTE.
7. CONTACT RESISTANCE : 初期 Initial : 20 m Ohm Max. ;  
测试后 Final : 40 m Ohm Max. .
8. OPERATING TEMPERATURE : - 40°C to +105°C.

THIS DRAWING IS A CONTROLLED DOCUMENT.		DWN 08012016	东莞市宇亮电子有限公司 DONG GUAN YU LIANG ELECTRONICS CO.,LTD	
		CHEK 08Jan2016		
 THIRD ANGLE PROJECTION		APVD Abel 08Jan2016	NAME Female Header 1.27mm*8.5mm Type	
		PRODUCT SPEC —	SIZE A4	DRAWING No. YL-ED-XXX
TOLERANCES UNLESS OTHERWISE SPECIFIED: 0 PLC ± 0.50 1 PLC ± 0.30 2 PLC ± 0.20 3 PLC ± 0.15 4 PLC ± — ANGLES ± 3°		WEIGHT —	SCALE 1 : 1 SHEET 1 of 1	
		CUSTOMER DRAWING		